

NOTES:
 Copyright Chetwoods (London) Limited. No implied licence exists.
 Contractors must verify all dimensions on site before commencing any work or shop drawings. This drawing is not to be scaled. Use figured dimensions only.
 Building areas are liable to adjustment over the course of the design process due to the ongoing construction detailing developments.
 Please note the information contained within this drawing is solely for the benefit of the employer and should not be relied upon by third parties.
 The CDM hazard management procedures for the Chetwoods aspects of the design of this project are to be found on the "Chetwoods - Hazard Analysis and Design Risk Assessment" and/or drawings. The full project design team's comprehensive set of hazard management procedures are available from the Principle Designer appointed for the project.

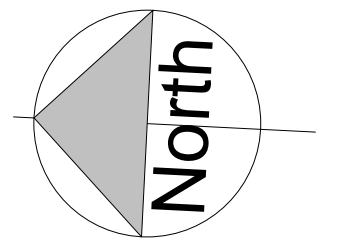

Third Floor GIA: 975 sq.m

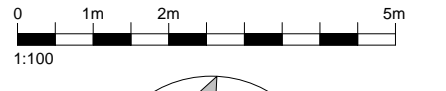
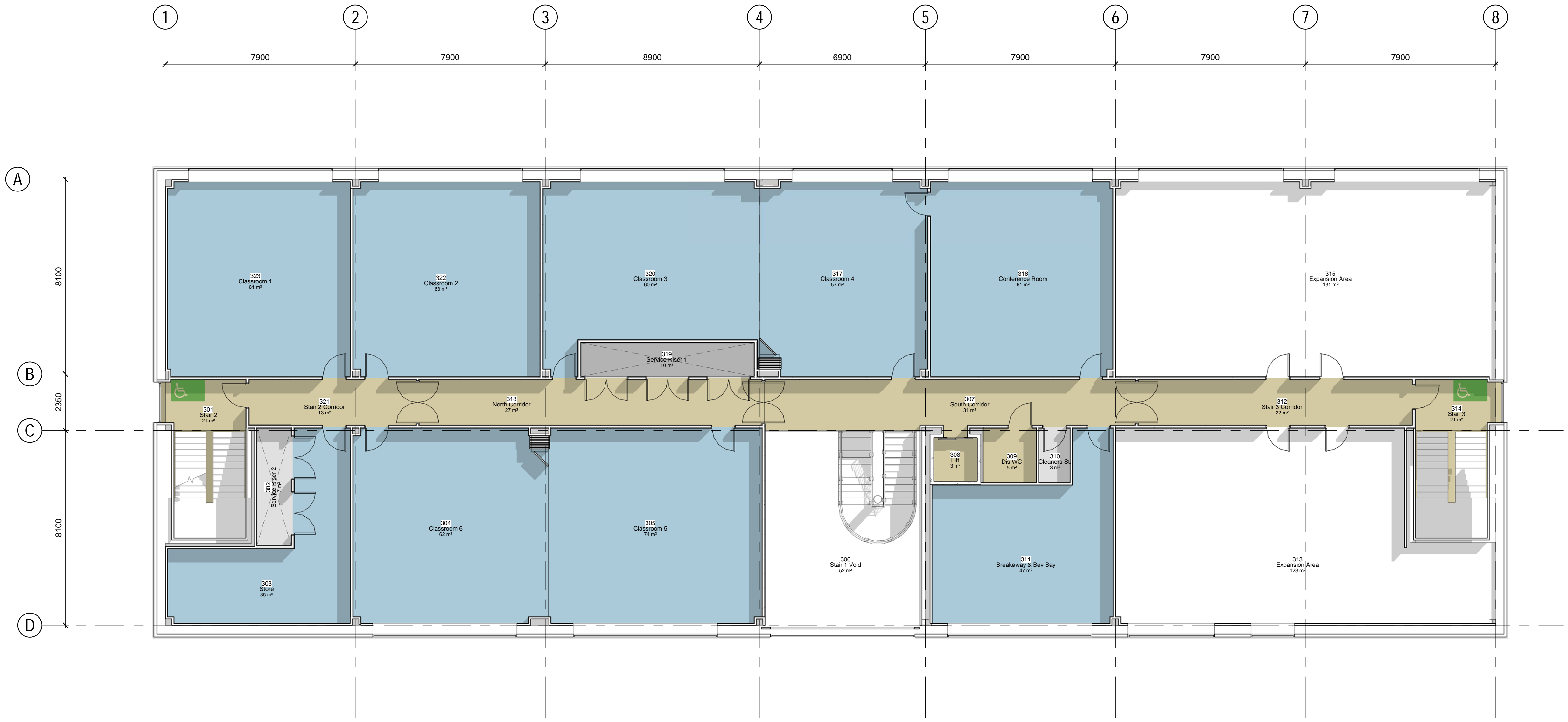

PL 3	Expansion area between GL 5-8 added	06/01/16	ST
PL 2	Revised to reflect VE scheme	22/12/17	ST
PL 1	Revised to reflect VE scheme	06/12/17	ST

Rev	Revision Description	Date	Author/Reviewer
-----	----------------------	------	-----------------

PLANNING

32 Frederick Street,
 Birmingham, B1 3HH

+44 (0)121 234 7500
 www.chetwoods.com



Project
SECURE TRAINING FACILITY

Client
ABP

Drawing Title
THIRD FLOOR GA PLAN

Scale	Size	Drawn	Checked	Date
1:100	A1	ST	TM	10/05/16

Project	Originator	Zone	Level	Type	Role	Number	Rev.
4079	CHT	00	03	DR	A	01203	PL 3