

No.420 Alnus glutinosa
No.420 Betula pubescens
No.168 Crataegus monogyna
No.336 Populus tremula
No.84 Rosa canina
No.168 Salix caprea
No.84 Sambucus nigra

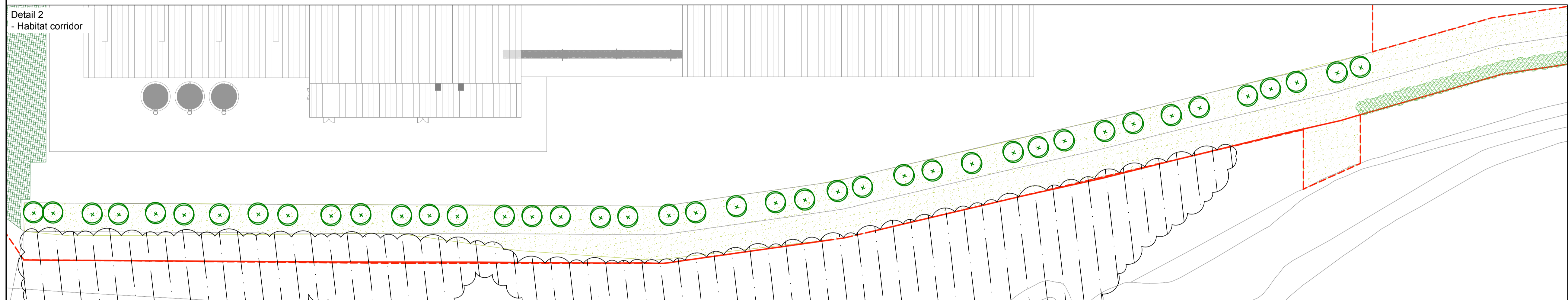
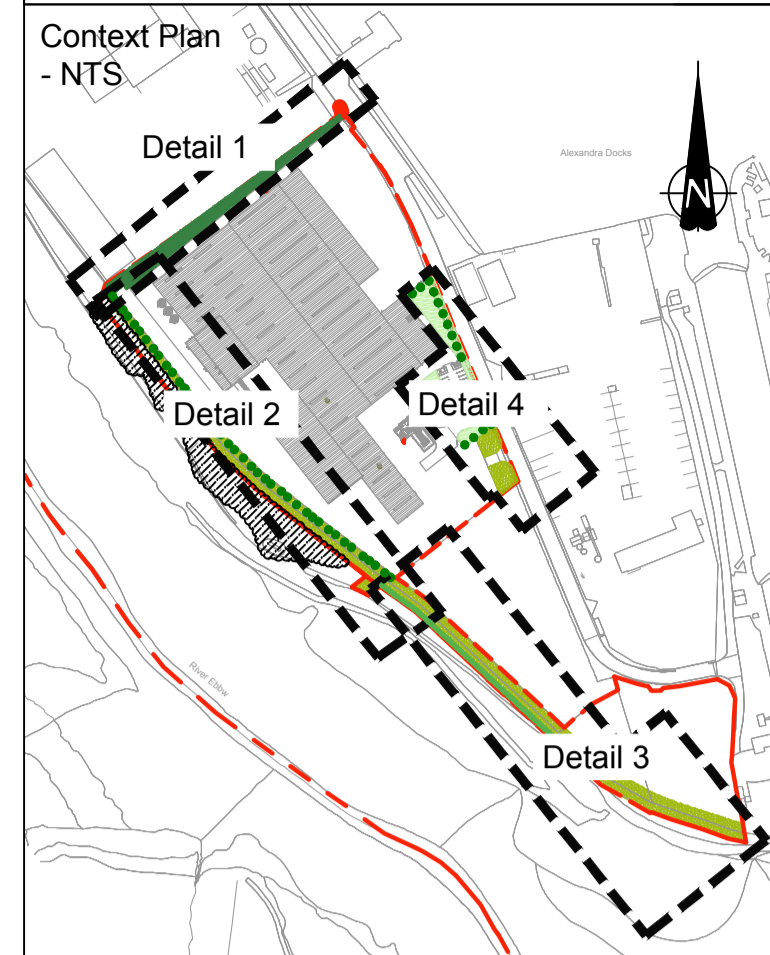
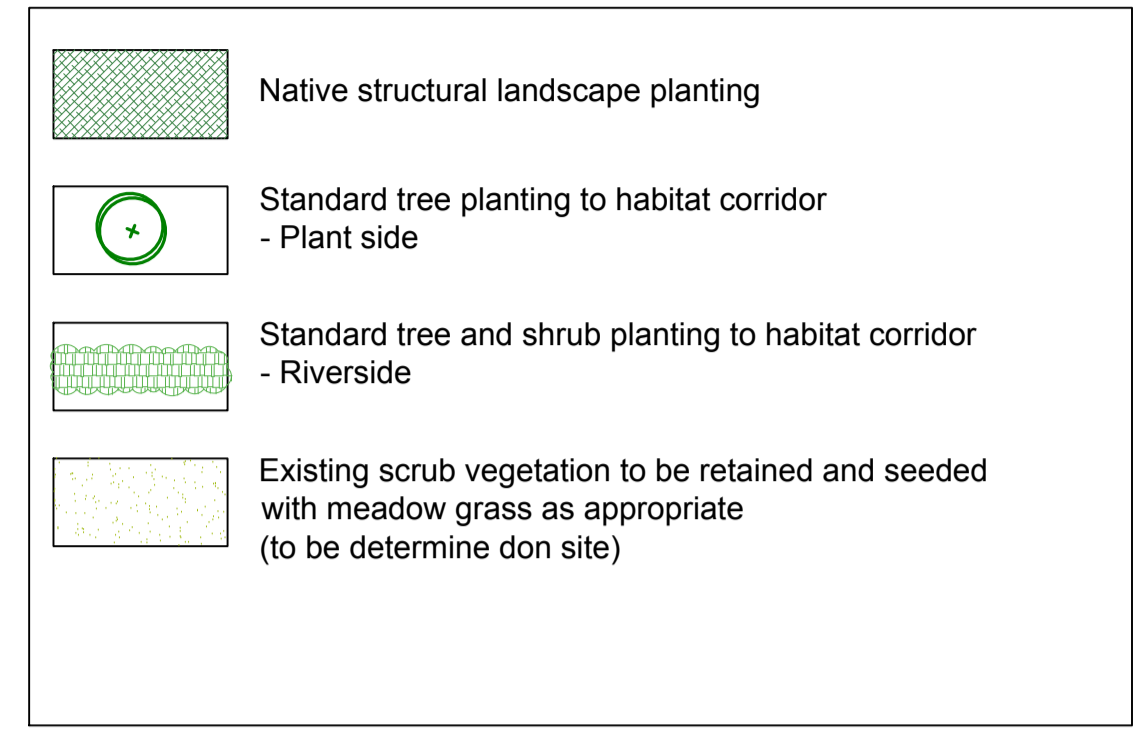

Planting Schedule

Grass Areas			
Seed Mix Name	Seed Mix Supplier	Density	
EH1 Hedgerow Mixture	Emorsgate Seeds	4g/m ²	

Structural Landscape Mix					
Number	Species	Height	Specification	Density	%
420	Alnus glutinosa	300-350cm	Standard :2x :Clear Stem min. 200 :B :4x	1.5/m ²	25%
420	Betula pubescens	250-300cm	Standard :2x :Clear Stem 175-200cm :B :3x	1.5/m ²	25%
168	Crataegus monogyna	125-150cm	Feather :2x :B	1.5/m ²	10%
336	Populus tremula	250-300cm	Feather :2x :Clear Stem 175-200 :B :3x	1.5/m ²	20%
84	Rosa canina	60-80cm	1+1 :B :Branched :3 brks	1.5/m ²	5%
168	Salix caprea	125-150cm	Feather :0/1/2 :B :3 Stems	1.5/m ²	10%
84	Sambucus nigra	80-100cm	1+1 :B :Branched :3 brks	1.5/m ²	5%
Total :1680					

Habitat Corridor - Riverside					
Number	Species	Height	Specification	Density	%
7	Alnus glutinosa	350-425cm	2x :Clear Stem min. 200 :B :5 brks	2Ctr	8%
11	Betula pubescens	350-400cm	Heavy Standard :3x :Clear Stem 175-200 :RB :5 brks	2Ctr	13.5%
19	Crataegus monogyna	100-125cm	Feather :x/1/0 :B :1 brks	2Ctr	23.5%
6	Populus tremula	250-300cm	Standard :2x :Clear Stem 175-200 :B :3 brks	2Ctr	7%
19	Prunus spinosa	80-100cm	1+2 :B :Branched :3 brks	2Ctr	23.5%
3	Rosa canina	60-80cm	1+1 :B :Branched :3 brks	2Ctr	3.5%
5	Salix alba	350-425cm	2x :Clear Stem 175-200 :B :5 brks	2Ctr	5%
9	Salix cinerea	125-150cm	0/2 :B :Branched :3 brks	2Ctr	10%
5	Sambucus nigra	80-100cm	1+1 :B :Branched :3 brks	2Ctr	6%
Total :84					

Habitat Corridor - Plant Side					
Number	Species	Height	Specification	Density	%
10	Alnus glutinosa	350-425cm	2x :Clear Stem min. 200 :B :5 brks	6Ctr	25%
16	Betula pubescens	350-400cm	Heavy Standard :3x :Clear Stem 175-200 :RB :5 brks	6Ctr	40%
8	Populus tremula	250-300cm	Standard :2x :Clear Stem 175-200 :B :3 brks	6Ctr	20%
6	Salix alba	350-425cm	2x :Clear Stem 175-200 :B :5 brks	6Ctr	15%
Total :40					

The linear habitat corridor adjacent to the plant is to be planted with standard trees from the specified mix @6m centres, offset 3m from the internal site boundary/hard standing surrounding the plant.

The riverside corridor is to be planted with standard trees at an average of 6m centres, no more 4-8m apart, with shrub planting to infill @2m centres.

Both sides of the corridor will be planted as a single line.

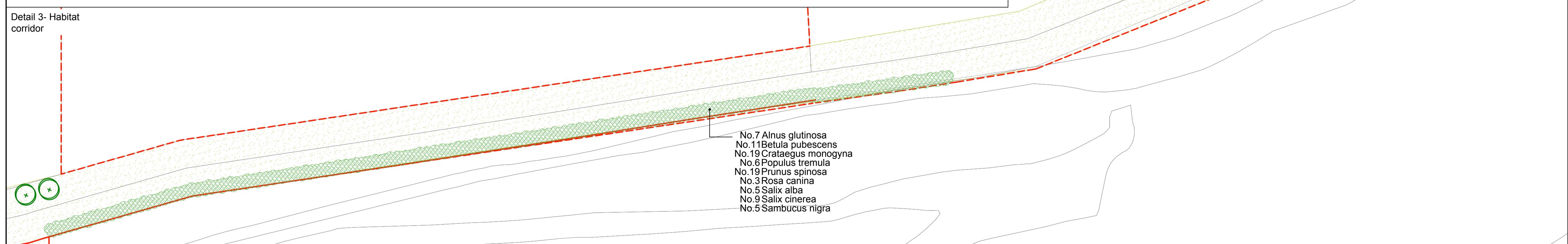

No.7 Alnus glutinosa
No.11 Betula pubescens
No.19 Crataegus monogyna
No.6 Populus tremula
No.19 Prunus spinosa
No.3 Rosa canina
No.5 Salix alba
No.9 Salix cinerea
No.5 Sambucus nigra

GENERAL PLANTING NOTES
Existing scrub within the habitat corridor will be retained, with new planting provided to enhance the existing habitat. Selective scrub / invasive species removal may be carried out within existing scrub areas, according to the direction on site by the supervising ecologist. Where planting is proposed in locations where existing trees / shrubs occur, the new plants should be redistributed to accommodate existing vegetation, as advised by the supervising ecologist.
Meadow grassland will be sown within the habitat corridor where appropriate to supplement existing vegetation and ground over.
Within the enhancement area, invasive species indicated for management (i.e. buddleja and willow) within the Ecological Management Plan (Wardell Armstrong, December 2019) are to be selectively removed to prevent the development of a dense covering of scrub and maintain an open mosaic habitat. Some specimens should be retained for the benefit of invertebrates. Specific plants for removal or retention are to be advised on site by the supervising ecologist.

- Tree protection shall be in place prior to works commencing, refer to the submitted Existing Vegetation Removal and Protection Plan. Any existing trees to be retained, are the responsibility of the main contractor on site who shall take all necessary protective measures set out in BS 5837:2012.
- All groundworks and planting operations shall be in accordance with the following British Standards:
- BS 3975 Glossary for Landscape Work -Part 4: Plant Description
- Part 5: Horticultural, Arboricultural and Forestry Practice BS 4428
General Landscape Operations
- All areas of proposed planting/grass seeding affected by construction works to be relieved of compaction by ripping to a depth of 600mm, in two directions. Following seeding/turfing, wet full depth of topsoil without displacing seed or soil. If water supply is likely to be restricted, do not carry out seeding/turfing until instructed. Works to be carried out while soil and weather conditions are suitable; do not plant during periods of frost or strong winds.
- Effective weed control shall be carried out prior to cultivation. Structural planting areas where applicable to be cultivated to a depth of 300mm, all proposed grass areas to be cultivated to a depth of 150mm, except within 4.0m of any existing tree stem, unless otherwise stated in the specification.
- Topsoil depths to be: 150mm mown grass and meadow margin areas; 450mm for shrub areas; 300mm for trees. Good quality on site topsoil can be used for tree, shrub and mown grass area. Topsoil shall be spread for grass areas flush with any areas of paving and after settlement, the soil level should be no greater than 10mm below paved areas to allow for turf. For areas to be grass seeded, the soil level shall be flush with any finished paved surfaces after settlement (or to a maximum of 5mm below) to allow for rain water to drain onto soft surfaces. Settlement shall be no greater than the tolerances given, or problems will be encountered with mowing (the blades in danger of touching concrete edging or where soil is proud of pavements, then drainage problems may be encountered). Tree Pits will be dug by the landscape contractor. Pits for containerised trees and shrubs (2L or 3L) to be 300 x 300 x 300mm. Pits for feathered trees and larger trees to be 1.2 x 1.2 x 0.6m (300mm topsoil, 300mm subsoil).
- Any deciduous trees and shrubs to be planted in late October to late March. Any conifers and evergreens to be planted in September/October or April/May. Container grown plants may be planted at any time of year.
- Apply peat-free tree and shrub planting compost by thoroughly incorporating it with topsoil into planting holes at the rate of 40 litres per feathered and standard trees.
- All shrubs, whips and transplants shall be watered in on planting with 20 litres per square metre. Trees shall be watered in with 25 litres per tree position. Standard trees including Containerised RB and BR, shall be supported by 1 No. 50mm diameter x 1200mm long stakes angled to avoid rootball and angled to the north with 400mm below ground level, tied with Standard Nylon Reinforced Rubber Belts, 37.5mm with Extra Large Pads spacer - supplied by J Toms Ltd or similar approved. Extra Heavy standard trees to be supported by 2no. 75mm diameter x 1900mm double-stake, cross-bar and tie.
- Surface mulching to be supplied to all individual trees in grass (500mm radius). Surface mulching to woodland mix to be 50mm depth of spent mushroom compost.
- Where considered necessary, native plants are to be protected with rabbit proof fencing installed prior to planting.
- Rabbit proof fencing where required to be 900mm high galvanised mesh with timber stakes. Mesh to be buried 150mm below ground, with 150mm angled away from planting and installed where shown on this drawing.

C	Revised building layout and hard standing	20.01.20	YK	KSM	KSM
B	Revised building layout	16.12.19	YK	KSM	KSM
REVISION	DETAILS	DATE	DRAWN	CHECKED	APPROVED
CLIENT					
Associated British Ports					
PROJECT					
New Manufacturing Plant Newport					
DRAWING TITLE					
Detailed Planting Plan - Sheet 1					
DRG No.	CA11637-011	REV	C		
DRG SIZE	A1	SCALE	1:500 @ A1	DATE	05.12.2019
DRAWN BY	YK	CHECKED BY	KS	APPROVED BY	KSM
<input checked="" type="checkbox"/> STONE ON TRENT TEL: 01782 276700 <input checked="" type="checkbox"/> WWW.WARDELLARMSTRONG.COM <input type="checkbox"/> BIRMINGHAM <input type="checkbox"/> GLASGOW <input type="checkbox"/> BOLTON <input type="checkbox"/> LEEDS <input type="checkbox"/> CARDIFF <input type="checkbox"/> LONDON <input type="checkbox"/> CARLISLE <input type="checkbox"/> MANCHESTER <input type="checkbox"/> EDINBURGH <input type="checkbox"/> NEWCASTLE UPON TYNE					